

# EV12 Top-valve

- aluminium version till 12 bar system pressure



Gauge optional

TECHNICAL DETAILS		APPLICATION AREA	DESCRIPTION
Body:	aluminium anodised	Shut off armature for cartridge pressure regulator.	The cartridge Top-valve was especially developed for gas extraction from cartridges / bottles.
Seal:	FPM (FKM / viton®)	Withdrawal of gas from cartridge pressure regulator.	The cartridge top valve can be combined with the cartridge pressure regulator ED 06 or with the flow meter E12.
Max. pressure:	12 bar		Low weight is a result of ergonomic design and compact dimensions, optimum handling and a minimum on gas-affected surfaces.
Operating temp.:	-20°C bis +60°C		The manometer shows the filling pressure of the cartridge.
Gauge:	safety version to EN 837-1 KL1,6		
Dimensions (wxhxd):	72 x 64 x 32 mm		
Weight:	115 g		
Connections:			
inlet:	UNEF 7/16"		
outlet:	NPT 1/8" f		

## QUALITY STANDARD

The company Hornung is certified to **ISO 9001:2015** and **ISO 14001:2015**. All single parts are manufactured, assembled and tested by in-house production. The finished parts are therefore under all criteria of German quality control with 100% final inspection.

# HORNUNG

Präzision made in Germany

Rathenaustraße 55  
63263 Neu-Isenburg

Phone: +49 6102 7883-70  
Fax: +49 6102 7883-40

www.hornung.org  
info@hornung.org

# EV 12

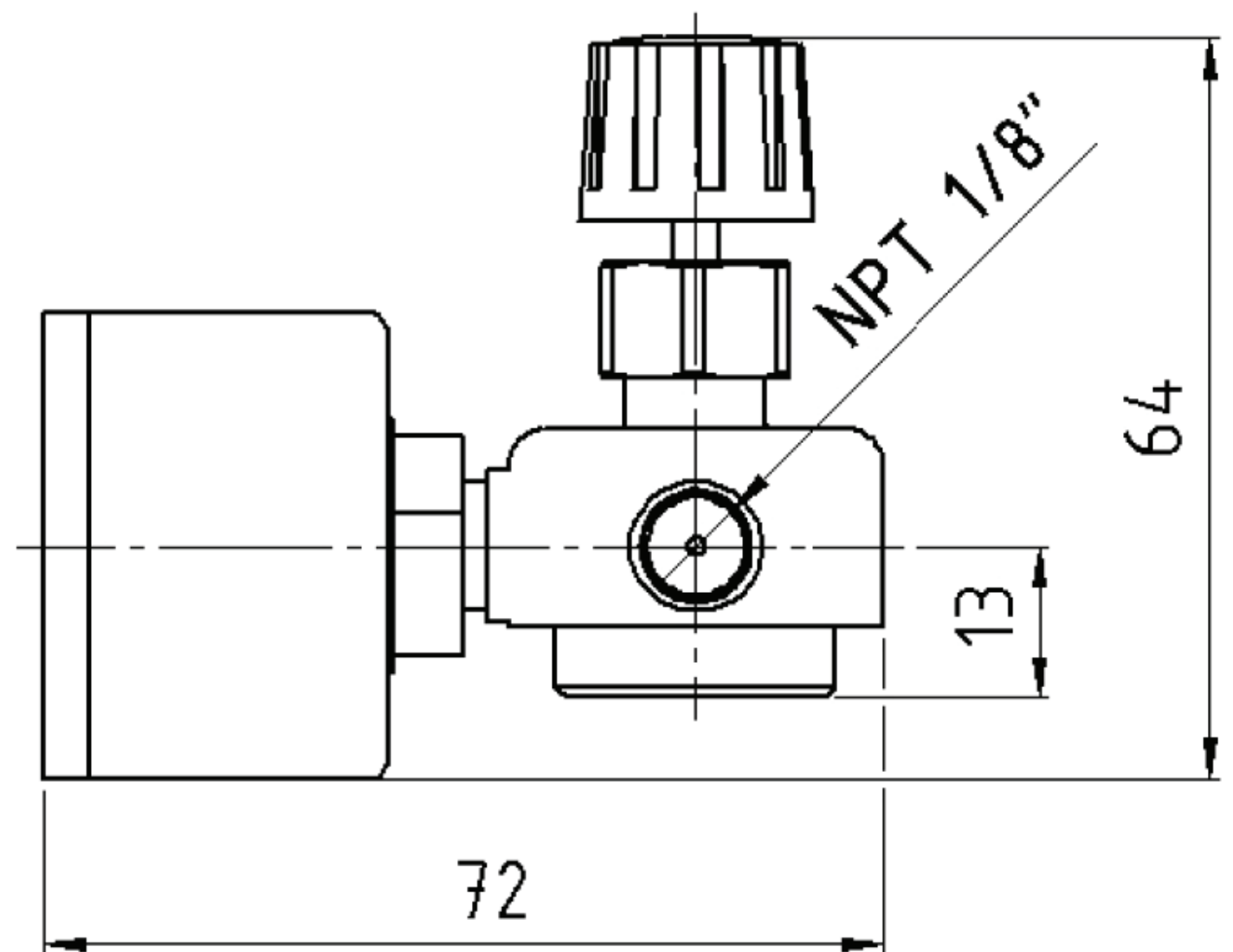
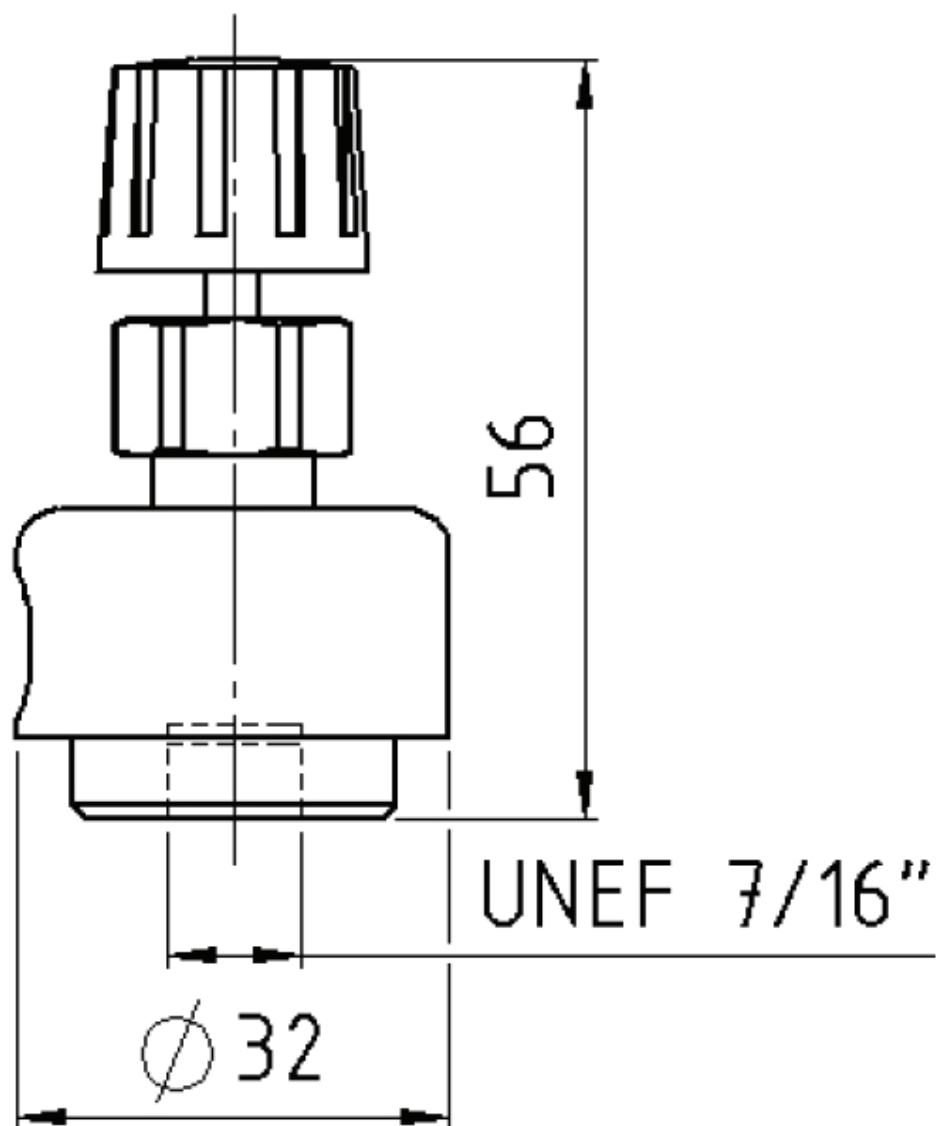

## ORDER DETAILS

### Gauge

- 0 = with gauge
- 1 = without gauge

### Outlet:

- 0 = NPT 1/8" f
- 1 = hose nozzle 3 mm bore
- 2 = compression fitting 3 mm
- 3 = compression fitting 6 mm

EV12-  
Type

1  
Gauge

1  
Outlet

**Accessories:** See total catalogue segment

7. Accessories, hose nozzles,  
friction ring fittings made from plastic,

friction ring fittings made of stainless steel,  
double nipples NPT 1/8 / UNEF 7/16"